

LOCK for Electric WINDOW, 24 and 48Vcc

Technical File
T 14511 E

VER1024E - VER1024R - VER1048E - VER1048R

Description - General Information

Lock designed to keep a smoke and heat exhaust window (S.H.E.V.) closed. Manual or distance control possible.

It can be installed in tandem on all windows with a width of more than 1200 mm.

Triggering is carried out either,

- by electric distance control,
 - mechanically, by traction of a steel cable
- or - manually.

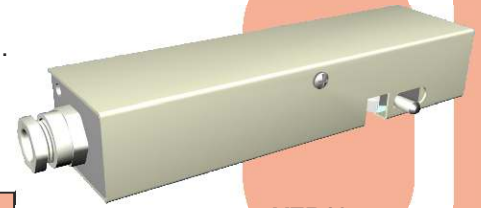

VER10 ...

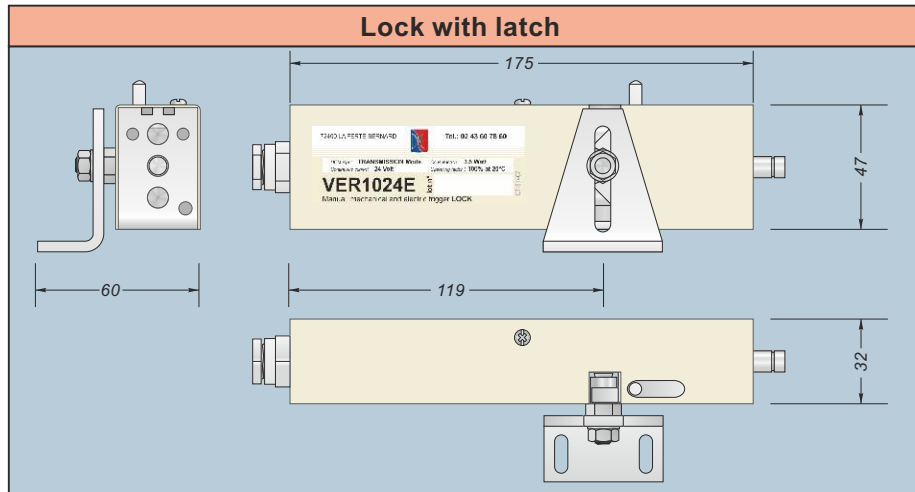

Reference	Voltage (Vcc)	Mode	Consump. (W)
VER1024E	24	Transm.	3.5
VER1024R	24	Break	1.8
VER1048E	48	Transm.	3.5
VER1048R	48	Break	1.8

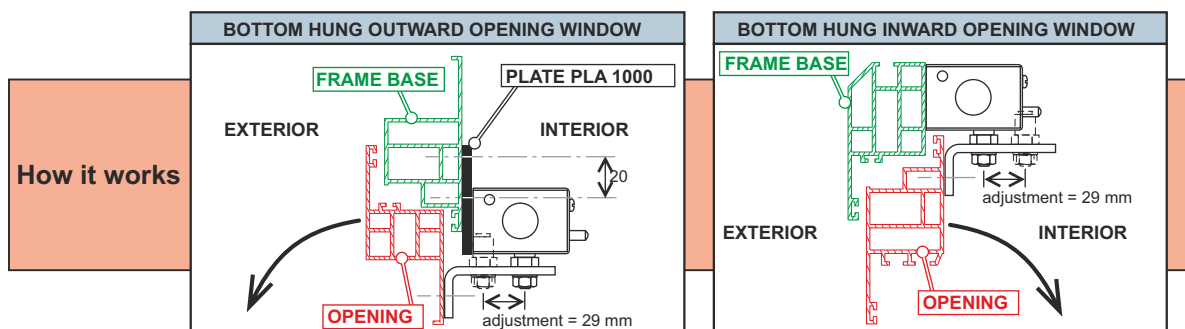
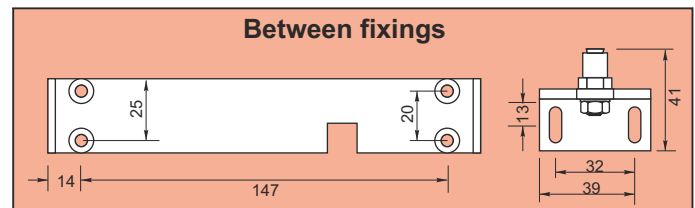
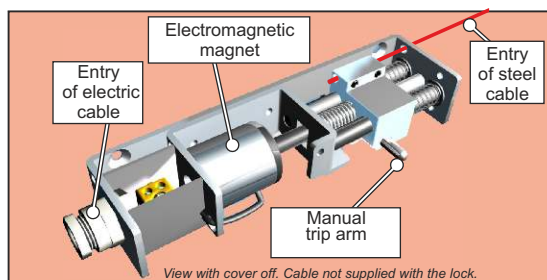

Technical Characteristics

- Material : Steel, aluminium.
- Protection : White zinc coating, RAL 1013 (cover).
- Energy : 24v or 48v cont. current S.E.L.V. / Manual
- Distance control input : By steel cable Ø 3 mm maximum.
- Cable lock : 2 clamping points with setscrews HC M4.
- Pulling direction : To the right : for bottom hung window, to the left : for top hung window.
- Protection index : IP42
- Electric distance control input : Electromagnetic magnet operated by transmission or break in current.
Operating factor : 100% at an ambient temperature of 20°C ± 5°C.
- Supply voltage (Un) : 24 or 48 volt cont. current S.E.L.V.
- Consumption under (Un) : 3.5 W (24 or 48 Vcc transmission).
1.8 W (24 or 48 Vcc break)
- Precautions : Stock and install away from bad weather conditions.



LOCK for Electric

WINDOW, 24 and 48Vcc

VER1024E - VER1024R - VER1048E - VER1048R

Example of installation

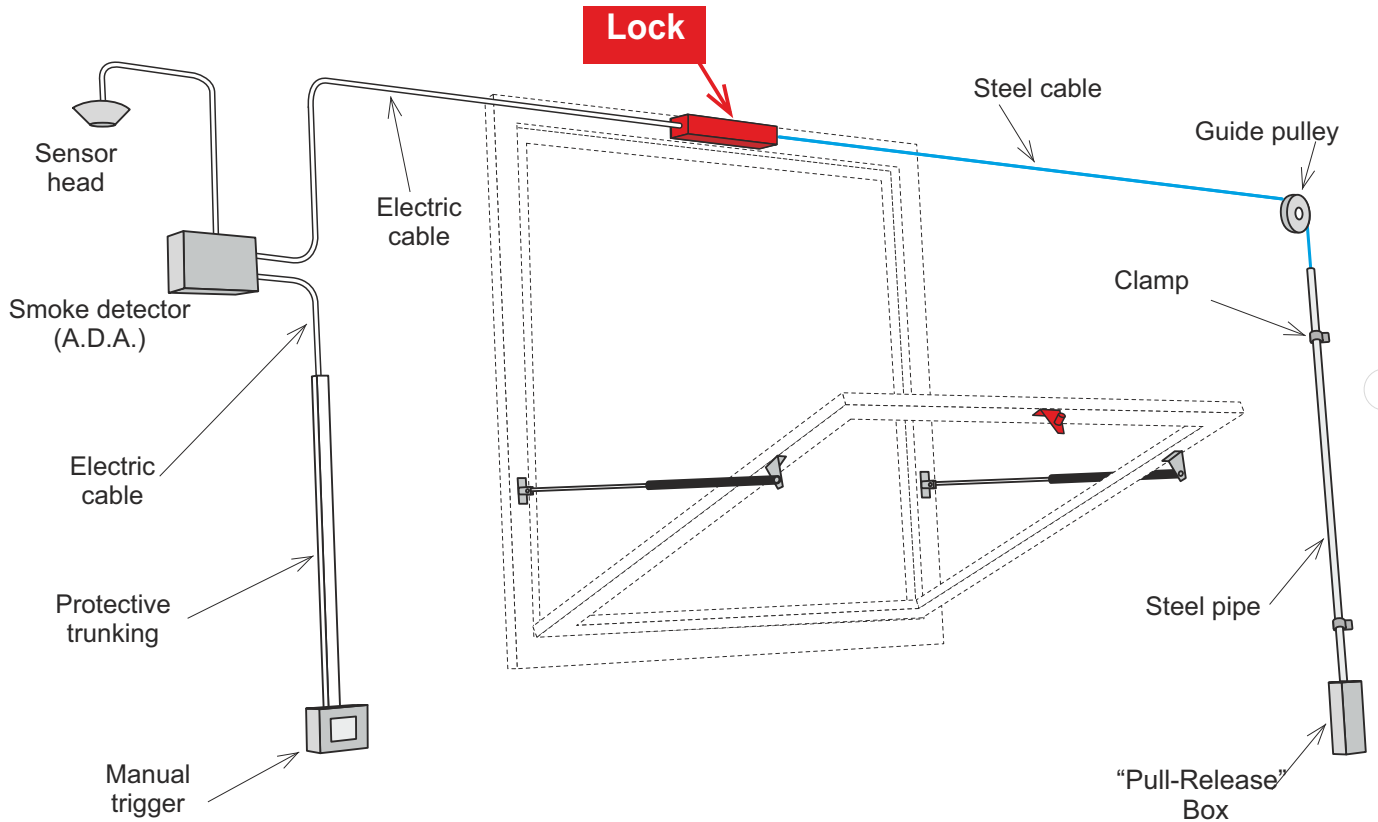

ALL RIGHTS RESERVED. OUR PRODUCTS MAY BE SUBJECT TO MODIFICATION, THEREFORE THIS DOCUMENT CANNOT BE CONSIDERED CONTRACTUAL. ALL MODELS ARE PATENTED. DO NOT LITTER THE PUBLIC HIGHWAY.

