

LOCK for Pneumatic WINDOW

Technical File
T 14509 F

VER1100

Description - General Information

Lock designed to keep a smoke and heat exhaust window (S.H.E.V.) closed. Manual or distance control possible.

It can be installed in tandem on all windows with a width of more than 1200 mm.

Triggering is carried out either,

- by pneumatic distance control,
 - mechanically, by traction of a steel cable,
- or
- manually.

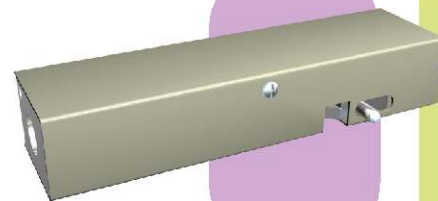

VER1100

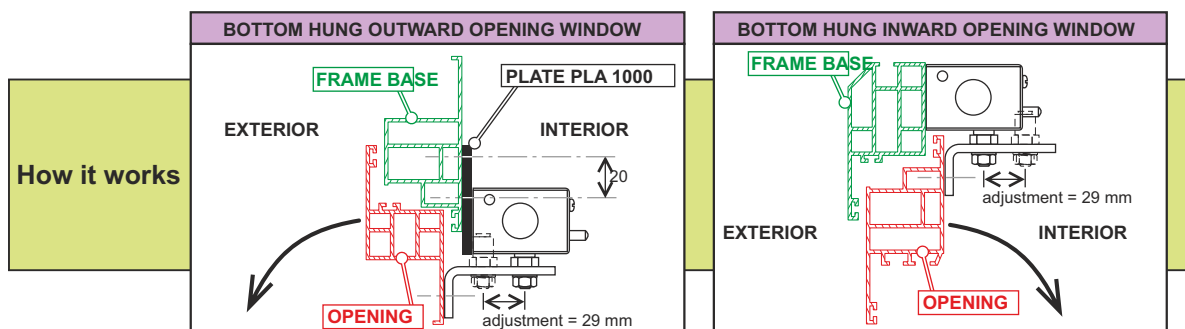
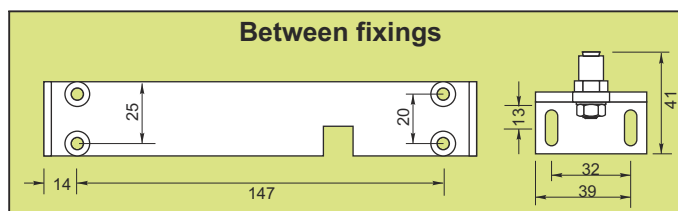
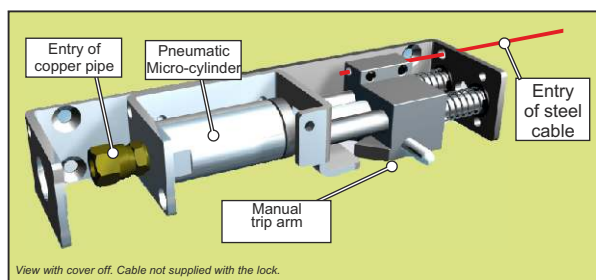
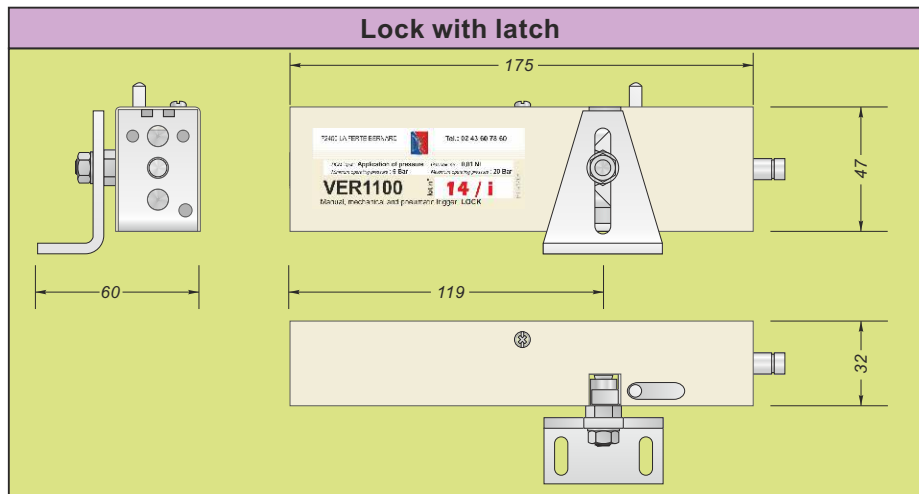

Technical Characteristics

- Material* : Steel, aluminium.
- Protection* : White zinc coating, RAL1013 (cover).
- Energy* : CO² or inert gas / Manual
- Distance control input* : By steel cable Ø 3 mm maximum.
- Cable lock* : 2 clamping points with setscrews HC M4.
- Pulling direction* : To the right : for bottom hung window, to the left : for top hung window.
- Pneumatic distance control input* : Micro-cylinder with olive screw connection.
Distance controlled by applying pressure.
Consumption = 0.01 Normo litre at atmospheric pressure.
Operating pressure = 6bar, pressure in use = 20bar, test pressure = 90bar
- Precautions* : Stock and install away from bad weather conditions.



LOCK for Pneumatic WINDOW

VER1100

Example of installation

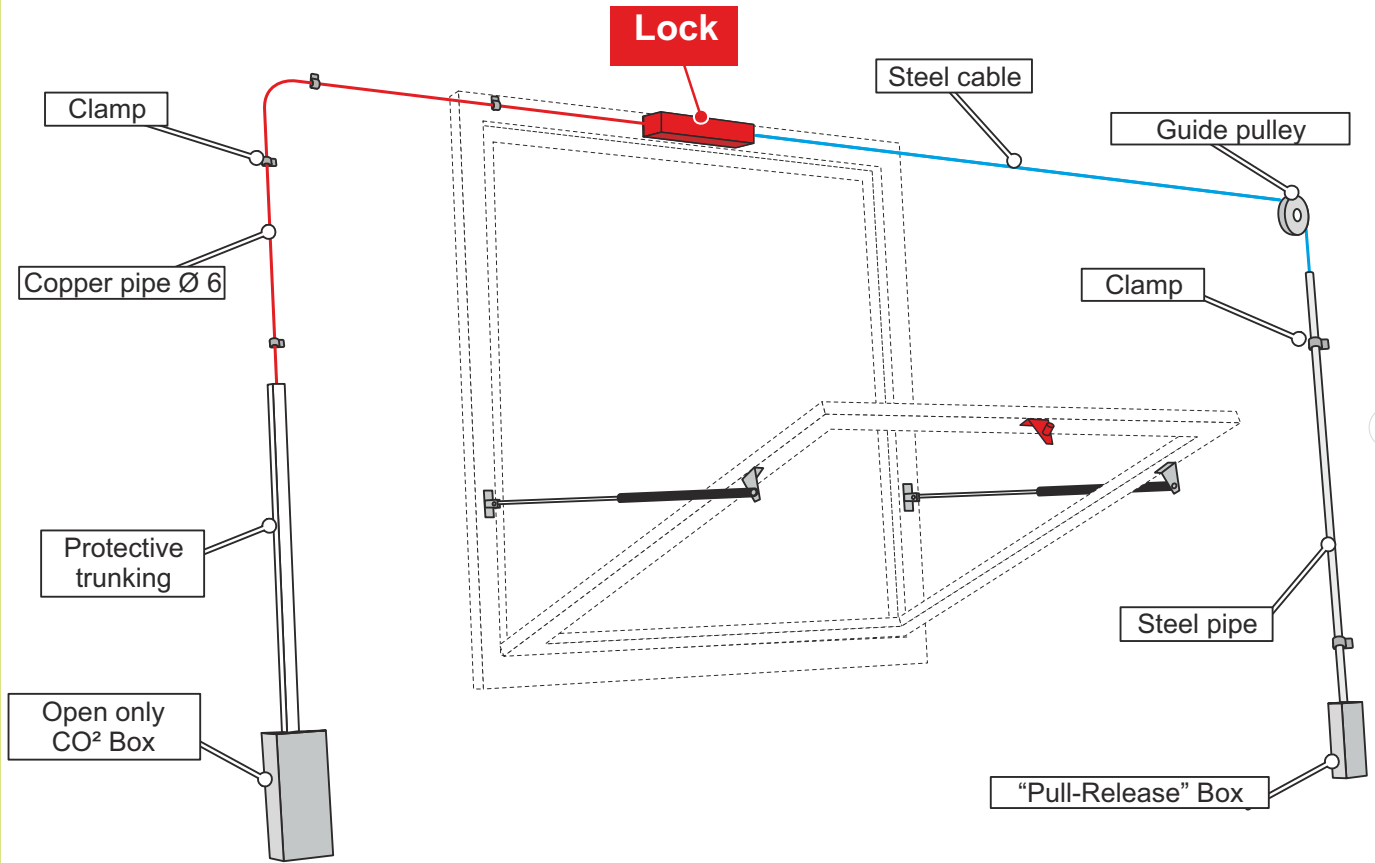

ALL RIGHTS RESERVED. OUR PRODUCTS MAY BE SUBJECT TO MODIFICATION. THEREFORE THIS DOCUMENT CANNOT BE CONSIDERED CONTRACTUAL. ALL MODELS ARE PATENTED. DO NOT LITTER THE PUBLIC HIGHWAY

